



# Conventional Stock QD Sheaves C

Dimensions in inches, weight in pounds

1 Groove											2 Groove								
F = 1 3/8											F = 2 3/8								
Part Number	PD C Belt	OD	Type	Bush	Bush Max. Bore	E	K	L Thru Bore	M	Wt. Less Bush	Part Number	Type	Bush	Bush Max. Bore	E	K	L Thru Bore	M	Wt. Less Bush
1 C 60 SK	6.00	6.40	C-1	SK	2 5/8	3/8	1/2	1 1/8	0	9.4	2 C 60 SF	A-1	SF	2 1/8	3/8	7/8	2 1/8	3/8	8.0
1 C 70 SF	7.00	7.40	C-1	SF	2 5/8	3/8	1/2	2 1/8	1/8	9.8	2 C 70 SF	A-1	SF	2 1/8	3/8	1 1/8	2 1/8	3/8	12.0
1 C 75 SF	7.50	7.90	C-1	SF	2 5/8	3/8	1/2	2 1/8	1/8	11.0	2 C 75 SF	A-1	SF	2 1/8	3/8	1 3/8	2 1/8	3/8	15.0
1 C 80 SF	8.00	8.40	C-1	SF	2 5/8	3/8	1/2	2 1/8	1/8	13.0	2 C 80 SF	A-1	SF	2 1/8	3/8	1 3/8	2 1/8	3/8	16.0
1 C 85 SF	8.50	8.90	C-1	SF	2 5/8	3/8	1/2	2 1/8	1/8	13.3	2 C 85 SF	A-2	SF	2 1/8	3/8	1 3/8	2 1/8	3/8	19.0
1 C 90 SF	9.00	9.40	C-3	SF	2 5/8	3/8	1/2	2 1/8	1/8	13.5	2 C 90 SF	A-2	SF	2 1/8	3/8	1 3/8	2 1/8	3/8	19.5
1 C 95 SF	9.50	9.90	C-3	SF	2 5/8	3/8	1/2	2 1/8	1/8	13.8	2 C 95 SF	A-2	SF	2 1/8	3/8	1 3/8	2 1/8	3/8	21.0
1 C 100 SF	10.00	10.40	C-3	SF	2 5/8	3/8	1/2	2 1/8	1/8	14.0	2 C 100 SF	A-2	SF	2 1/8	3/8	1 3/8	2 1/8	3/8	22.0
1 C 105 SF	10.50	10.90	C-3	SF	2 5/8	3/8	1/2	2 1/8	1/8	15.0	2 C 105 SF	A-2	SF	2 1/8	3/8	1 3/8	2 1/8	3/8	25.0
1 C 110 SF	11.00	11.40	C-3	SF	2 5/8	3/8	1/2	2 1/8	1/8	15.8	2 C 110 SF	A-3	SF	2 1/8	3/8	1 3/8	2 1/8	3/8	26.0
1 C 120 SF	12.00	12.40	C-3	SF	2 5/8	3/8	1/2	2 1/8	1/8	17.0	2 C 120 SF	D-3	SF	2 1/8	3/8	1 3/8	2 1/8	3/8	29.0
1 C 130 SF	13.00	13.40	C-3	SF	2 5/8	3/8	1/2	2 1/8	1/8	18.0	2 C 130 SF	D-3	SF	2 1/8	3/8	1 3/8	2 1/8	3/8	31.0
1 C 140 SF	14.00	14.40	C-3	SF	2 5/8	3/8	1/2	2 1/8	1/8	20.0	2 C 140 SF	D-3	SF	2 1/8	3/8	1 3/8	2 1/8	3/8	35.0
1 C 150 SF	15.00	15.40	C-3	SF	2 5/8	3/8	1/2	2 1/8	1/8	21.0	2 C 150 SF	D-3	SF	2 1/8	3/8	1 3/8	2 1/8	3/8	39.0
1 C 160 SF	16.00	16.40	C-3	SF	2 5/8	3/8	1/2	2 1/8	1/8	24.0	2 C 160 SF	D-3	SF	2 1/8	3/8	1 3/8	2 1/8	3/8	43.0
1 C 180 SF	18.00	18.40	C-3	SF	2 5/8	3/8	1/2	2 1/8	1/8	27.0	2 C 180 SF	D-3	SF	2 1/8	3/8	1 3/8	2 1/8	3/8	48.0
1 C 200 SF	20.00	20.40	C-3	SF	2 5/8	3/8	1/2	2 1/8	1/8	31.0	2 C 200 SF	D-3	SF	2 1/8	3/8	1 3/8	2 1/8	3/8	55.0
1 C 240 SF	24.00	24.40	C-3	SF	2 5/8	3/8	1/2	2 1/8	1/8	37.0	2 C 240 SF	D-3	SF	2 1/8	3/8	1 3/8	2 1/8	3/8	65.0
	27.00	27.40									2 C 270 F	C-3	F	3 1/8	1 1/8	5/8	3 3/8	3/8	107.0
	30.00	30.40									2 C 300 F	C-3	F	3 1/8	1 1/8	5/8	3 3/8	3/8	115.0

V-BELT DRIVES

Dimensions in inches, weight in pounds

3 Groove											4 Groove									
F = 3 3/8											F = 4 3/8									
Part Number	PD C Belt	OD	Type	Bush	Bush Max. Bore	E	K	L Thru Bore	M	Wt. Less Bush	Part Number	Type	Bush	Bush Max. Bore	E	K	L Thru Bore	M	Wt. Less Bush	
3 C 50 SD	5.00	5.40	A-1	SD	2	3/8	1 1/4	1 1/8	1 5/8	8.0	4 C 50 SD	A-1	SD	2	5/8	1 1/4	1 1/8	1 1/8	1 1/8	10.0
3 C 54 SD	5.40	5.80	A-1	SD	2	1 1/8	1 1/8	1 1/8	7/8	9.0	4 C 54 SD	A-1	SD	2	1 1/8	1 1/8	1 1/8	1 1/8	1 1/8	12.0
3 C 55 SD	5.50	5.90	A-1	SD	2	1 1/8	1 1/8	1 1/8	7/8	10.0	4 C 55 SD	A-1	SD	2	1 1/8	1 1/8	1 1/8	1 1/8	1 1/8	12.4
3 C 56 SD	5.60	6.00	A-1	SD	2	1 1/8	1 1/8	1 1/8	7/8	11.0	4 C 56 SD	A-1	SD	2	1 1/8	1 1/8	1 1/8	1 1/8	1 1/8	12.4
3 C 60 SF	6.00	6.40	A-1	SF	2 1/8	3/8	1/2	2 1/8	1 1/8	12.0	4 C 60 SF	A-1	SF	2 1/8	3/8	1/2	2 1/8	1 1/8	1 1/8	12.6
3 C 70 SF	7.00	7.40	A-1	SF	2 1/8	3/8	1/2	2 1/8	1 1/8	14.0	4 C 70 SF	A-2	SF	2 1/8	3/8	1/2	1 1/8	2 1/8	1 1/8	13.0
3 C 75 SF	7.50	7.90	A-1	SF	2 1/8	3/8	1/2	2 1/8	1 1/8	17.0	4 C 75 SF	A-2	SF	2 1/8	3/8	1/2	1 1/8	2 1/8	1 1/8	19.0
3 C 80 E	8.00	8.40	B-1	E	3 1/2	7/8	1 1/2	2 1/2	1 1/2	19.0	4 C 80 E	A-2	E	3 1/2	1 1/2	2	2 1/2	1 1/2	24.0	
3 C 85 E	8.50	8.90	B-1	E	3 1/2	7/8	1 1/2	2 1/2	1 1/2	22.0	4 C 85 E	A-1	E	3 1/2	1 1/2	2	2 1/2	1 1/2	27.0	
3 C 90 E	9.00	9.40	B-1	E	3 1/2	7/8	1 1/2	2 1/2	1 1/2	26.0	4 C 90 E	A-1	E	3 1/2	1 1/2	2	2 1/2	1 1/2	30.0	
3 C 95 E	9.50	9.90	B-1	E	3 1/2	7/8	1 1/2	2 1/2	1 1/2	29.0	4 C 95 E	A-1	E	3 1/2	1 1/2	2	2 1/2	1 1/2	33.0	
3 C 100 E	10.00	10.40	B-1	E	3 1/2	7/8	1 1/2	2 1/2	1 1/2	27.0	4 C 100 E	A-1	E	3 1/2	1 1/2	2	2 1/2	1 1/2	35.0	
3 C 105 E	10.50	10.90	B-2	E	3 1/2	7/8	1 1/2	2 1/2	1 1/2	31.0	4 C 105 E	A-2	E	3 1/2	1 1/2	2	2 1/2	1 1/2	40.0	
3 C 110 E	11.00	11.40	B-2	E	3 1/2	7/8	1 1/2	2 1/2	1 1/2	38.0	4 C 110 E	A-1	E	3 1/2	1 1/2	2	2 1/2	1 1/2	45.0	
3 C 120 E	12.00	12.40	B-3	E	3 1/2	7/8	1 1/2	2 1/2	1 1/2	40.0	4 C 120 E	A-1	E	3 1/2	1 1/2	2	2 1/2	1 1/2	48.0	
3 C 130 E	13.00	13.40	B-3	E	3 1/2	7/8	1 1/2	2 1/2	1 1/2	43.0	4 C 130 E	A-3	E	3 1/2	1 1/2	2	2 1/2	1 1/2	49.0	
3 C 140 E	14.00	14.40	B-3	E	3 1/2	7/8	1 1/2	2 1/2	1 1/2	46.0	4 C 140 E	A-3	E	3 1/2	1 1/2	2	2 1/2	1 1/2	56.0	
3 C 150 E	15.00	15.40	B-3	E	3 1/2	7/8	1 1/2	2 1/2	1 1/2	52.0	4 C 150 E	A-3	E	3 1/2	1 1/2	2	2 1/2	1 1/2	62.0	
3 C 160 E	16.00	16.40	B-3	E	3 1/2	7/8	1 1/2	2 1/2	1 1/2	58.0	4 C 160 E	A-3	E	3 1/2	1 1/2	2	2 1/2	1 1/2	68.0	
3 C 180 E	18.00	18.40	B-3	E	3 1/2	7/8	1 1/2	2 1/2	1 1/2	67.0	4 C 180 E	A-3	E	3 1/2	1 1/2	2	2 1/2	1 1/2	74.0	
3 C 200 E	20.00	20.40	A-3	E	3 1/2	7/8	1	2 1/2	5/8	70.0	4 C 200 E	A-3	E	3 1/2	5/8	1 1/2	2 1/2	1 1/2	81.0	
3 C 240 E	24.00	24.40	A-3	E	3 1/2	7/8	1	2 1/2	5/8	90.0	4 C 240 F	A-3	F	3 3/8	5/8	1 1/2	3 1/2	7/8	120.0	
3 C 270 F	27.00	27.40	C-3	F	3 3/8	3/8	1 1/2	3 3/8	1 1/2	124.0	4 C 270 F	A-3	F	3 3/8	5/8	1 1/2	3 3/8	7/8	138.0	
3 C 300 F	30.00	30.40	C-3	F	3 3/8	3/8	1 1/2	3 3/8	1 1/2	130.0	4 C 300 F	A-3	F	3 3/8	5/8	1 1/2	3 3/8	7/8	166.0	
3 C 360 F	36.00	36.40	C-3	F	3 3/8	3/8	1 1/2	3 3/8	1 1/2	166.0	4 C 360 F	A-3	F	3 3/8	5/8	1 1/2	3 3/8	7/8	176.0	
3 C 440 F	44.00	44.40	C-3	F	3 3/8	3/8	1 1/2	3 3/8	1 1/2	208.0	4 C 440 J	B-3	J	4 1/2	3/8	1 1/2	4 1/2	1/2	254.0	
3 C 500 F	50.00	50.40	C-3	F	3 3/8	3/8	1 1/2	3 3/8	1 1/2	250.0	4 C 500 J	B-3	J	4 1/2	3/8	1 1/2	4 1/2	1/2	318.0	

Weights do not include bushings. See page B-7 for additional bushing dimensions.

# C Conventional Stock QD Sheaves

# Martin

V-BELT DRIVES

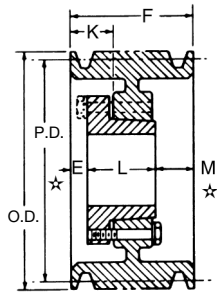

TYPE A

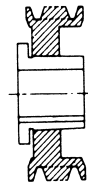

1 = SOLID

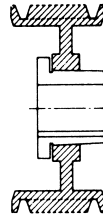

2 = WEB

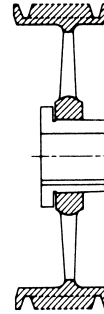

3 = ARM/SPOKE

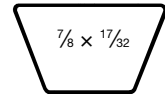

C

Dimensions in inches, weight in pounds

5 Groove F = 5 3/8											6 Groove F = 6 3/8								
Part Number	PD		Type	Bush	Bush Max. Bore	E	K	L Thru Bore	M	Wt. Less Bush	Part Number	Type	Bush	Bush Max. Bore	E	K	L Thru Bore	M	Wt. Less Bush
	C Belt	OD																	
5 C 60 SF	6.00	6.40	A-1	SF	2 15/16	3/8	7/8	2 1/16	3 3/8	14.0	6 C 60 SF	A-1	SF	2 15/16	3/8	7/8	2 1/16	4 1/8	16.0
5 C 70 SF	7.00	7.40	A-1	SF	2 15/16	1 1/4	1 15/16	2 1/16	2 1/16	19.0	6 C 70 SF	A-1	SF	2 15/16	1 1/4	1 15/16	2 1/16	3 3/8	22.0
5 C 75 SF	7.50	7.90	A-1	SF	2 15/16	1 1/4	1 15/16	2 1/16	2 1/16	22.0	6 C 75 SF	A-1	SF	2 15/16	1 1/4	1 15/16	2 1/16	3 3/8	25.0
5 C 80 E	8.00	8.40	A-1	E	3 1/2	1 1/2	2 3/8	2 3/8	1 1/4	28.0	6 C 80 E	A-1	E	3 1/2	1 1/2	2 3/8	2 3/8	2 1/2	31.0
5 C 85 E	8.50	8.90	A-1	E	3 1/2	1 1/2	2 3/8	2 3/8	1 1/4	31.0	6 C 85 E	A-1	E	3 1/2	1 1/2	2 3/8	2 3/8	2 1/2	35.0
5 C 90 E	9.00	9.40	A-1	E	3 1/2	1 1/2	2 3/8	2 3/8	1 1/4	32.0	6 C 90 F	A-1	F	3 15/16	1 1/8	2 1/8	3 3/8	1 3/8	40.0
5 C 95 E	9.50	9.90	A-1	E	3 1/2	1 1/2	2 3/8	2 3/8	1 1/4	36.0	6 C 95 F	A-1	F	3 15/16	1 1/8	2 1/8	3 3/8	1 3/8	44.0
5 C 100 E	10.00	10.40	A-2	E	3 1/2	1 1/2	2 3/8	2 3/8	1 1/4	38.0	6 C 100 F	A-1	F	3 15/16	1 1/8	2 1/8	3 3/8	1 3/8	50.0
5 C 105 E	10.50	10.90	A-2	E	3 1/2	1 1/2	2 3/8	2 3/8	1 1/4	43.0	6 C 105 F	A-1	F	3 15/16	1 1/8	2 1/8	3 3/8	1 3/8	56.0
5 C 110 E	11.00	11.40	A-1	E	3 1/2	1 1/2	2 3/8	2 3/8	1 1/4	50.0	6 C 110 F	A-1	F	3 15/16	1 1/8	2 1/8	3 3/8	1 3/8	60.0
5 C 120 E	12.00	12.40	A-1	E	3 1/2	1 1/2	2 3/8	2 3/8	1 1/4	55.0	6 C 120 F	A-1	F	3 15/16	1 1/8	2 1/8	3 3/8	1 3/8	65.0
5 C 130 E	13.00	13.40	A-3	E	3 1/2	1 1/2	2 3/8	2 3/8	1 1/4	58.0	6 C 130 F	A-3	F	3 15/16	1 1/8	2 1/8	3 3/8	1 3/8	67.0
5 C 140 E	14.00	14.40	A-3	E	3 1/2	1 1/2	2 3/8	2 3/8	1 1/4	61.0	6 C 140 F	A-3	F	3 15/16	1 1/8	2 1/8	3 3/8	1 3/8	75.0
5 C 150 E	15.00	15.40	A-3	E	3 1/2	1 1/2	2 3/8	2 3/8	1 1/4	69.0	6 C 150 F	A-3	F	3 15/16	1 1/8	2 1/8	3 3/8	1 3/8	91.0
5 C 160 E	16.00	16.40	A-3	E	3 1/2	1 1/2	2 3/8	2 3/8	1 1/4	75.0	6 C 160 F	A-3	F	3 15/16	1 1/8	2 1/8	3 3/8	1 3/8	93.0
5 C 180 E	18.00	18.40	A-3	E	3 1/2	1 1/2	2 3/8	2 3/8	1 1/4	85.0	6 C 180 F	A-3	F	3 15/16	1 1/8	2 1/8	3 3/8	1 3/8	106.0
5 C 200 F	20.00	20.40	A-3	F	3 3/16	5/16	1 1/8	3 3/8	1 1/8	108.0	6 C 200 F	A-3	F	3 15/16	1 5/16	1 3/8	3 3/8	1 3/8	125.0
5 C 240 F	24.00	24.40	A-3	F	3 3/16	5/16	1 1/8	3 3/8	1 1/8	124.0	6 C 240 F	A-3	F	3 15/16	1 5/16	1 3/8	3 3/8	1 3/8	162.0
5 C 270 F	27.00	27.40	A-3	F	3 3/16	5/16	1 1/8	3 3/8	1 1/8	154.0	6 C 270 J	A-3	J	3 15/16	3/8	1 3/8	4 1/2	1 1/2	190.0
5 C 300 F	30.00	30.40	A-3	F	3 3/16	5/16	1 1/8	3 3/8	1 1/8	174.0	6 C 300 J	A-3	J	4 1/2	3/8	1 3/8	4 1/2	1 1/2	229.0
5 C 360 J	36.00	36.40	A-3	J	4 1/2	3/8	1 3/8	4 1/2	1/2	226.0	6 C 360 J	A-3	J	4 1/2	3/8	1 3/8	4 1/2	1 1/2	270.0
5 C 440 J	44.00	44.40	A-3	J	4 1/2	3/8	1 3/8	4 1/2	1/2	289.0	6 C 440 J	A-3	J	4 1/2	3/8	1 3/8	4 1/2	1 1/2	301.0
5 C 500 J	50.00	50.40	A-3	J	4 1/2	3/8	1 3/8	4 1/2	1/2	316.0	6 C 500 M	B-3	M	5 1/2	1/2	1 3/8	6 1/2	7/8	444.0

★ E and M dimensions are nominal and will vary depending on shaft tolerances. Type E sheaves are drilled for reverse mounting only.